

# Tolerances

Plain Bearings:

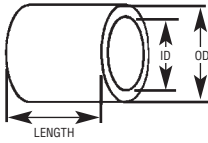

Flanged Bearings:

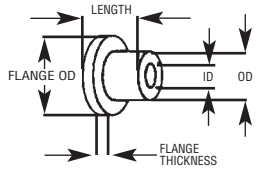

## PLAIN & FLANGED BEARINGS

### Inside & Outside Diameters (Inches)

OVER (INCHES)	UP TO & INCLUDING	TOLERANCE
-	1/2	+ .000 - .001
1/2	1	+ .000 - .001
1	1-1/2	+ .000 - .001
1-1/2	2-1/2	+ .000 - .0015
2-1/2	3-1/2	+ .000 - .002
3-1/2	4-1/2	+ .000 - .0025
4-1/2	5-1/2	+ .000 - .0035
5-1/2	6-1/2	+ .000 - .004

### Length (Inches)

OVER (INCHES)	UP TO & INCLUDING	TOLERANCE
-	1-1/2	± .005
1-1/2	3	± .0075
3	4-1/2	± .010
4-1/2	6	± .015

### Flange Diameter - Based on Flange OD

OVER (INCHES)	UP TO & INCLUDING	TOLERANCE
-	1-1/4	± .005
1-1/4	2-1/2	± .010
2-1/2	4	± .015
4	4-1/2	± .025

### Flange Thickness - Based on Flange OD

OVER (INCHES)	UP TO & INCLUDING	TOLERANCE
-	1-1/4	± .0025
1-1/4	2-1/2	± .005

### Flange Fillets, Radii - Based on Body OD

OVER (INCHES)	UP TO & INCLUDING	TOLERANCE MAX. TYPICAL
-	1	1/32
1	2	3/64
2	2-1/2	1/16
2-1/2	4	3/32

### Concentricity, ID with respect to OD (Maximum Total Dial Indicator Reading) - Based on ID

OVER (INCHES)	UP TO & INCLUDING	TOLERANCE
-	1	.003
1	1-1/2	.003
1-1/2	3	.004
3	4-1/2	.005
4-1/2	6	.006

# Tolerances



## Thrust Bearings

### Inside Diameter

OVER (INCHES)	UP TO & INCLUDING	TOLERANCE
-	1-1/4	± .005
1-1/4	2-1/2	± .010
2-1/2	4	± .015
THICKNESS		± .0025

### Outside Diameter

OVER (INCHES)	UP TO & INCLUDING	TOLERANCE
-	1-1/2	± .010
1-1/2	3	± .015
3	4-1/2	± .020

### Parallelism of Faces - Based on OD

OVER (INCHES)	UP TO & INCLUDING	TOLERANCE
-	1-1/2	.003
1-1/2	3-1/2	.004
3-1/2	4	.005

## Running Clearance

Proper running clearance for bearings depends to a great extent on the particular application. Only minimum recommended clearances for oil impregnated bearings used with the ground steel shafting are listed.

### Clearance, Min. In.

SHAFT SIZE, IN.	BRONZE BASE	IRON BASE
Up to 0.760	0.0005	0.001
0.761 to 1.510	0.001	0.0015
1.511 to 2.510	0.0015	0.002
Over 2.510	0.002	0.0025

## Press Fits

Plain cylindrical journal bearings are commonly installed by press fitting the bearing into a housing with an insertion arbor. For housings rigid enough to withstand the press fit without appreciable distortion and for bearings with thickness approximately one-eighth of the bearing outside diameter, the press fits shown are recommended.

### Press Fit In.

OUTSIDE DIAMETER IN.	MINIMUM	MAXIMUM
Up to 0.760	0.001	0.003
0.761 to 1.510	0.0015	0.004
1.511 to 2.510	0.002	0.005
2.511 to 3.010	0.002	0.006
Over 3.010	0.002	0.007